

T. Barrett and Associates  
P.O. Box 5069  
Louisville, KY 40255  
Office: 502-365-1462  
Fax: 502-290-2091  
admin@tbaclaims.com

Insured: Winchester Village Apartments  
Property: 5667-5683 Weatherby Loop  
Canal Winchester, OH 43110

Home: (614) 431-4434

Claim Rep.: Bob Greaser  
Company: T. Barrett and Associates

Business: (317) 522-6757  
E-mail: bobgreaser@yahoo.com

Estimator: Bob Greaser  
Company: T. Barrett and Associates

Business: (317) 522-6757  
E-mail: bobgreaser@yahoo.com

**Claim Number:** 2BDH2

**Policy Number:** HEICP-251345-

**Type of Loss:** Wind Damage

Date Contacted: 5/2/2024 9:47 PM

Date of Loss: 3/14/2024 9:47 PM

Date Received: 5/2/2024 9:47 PM

Date Inspected: 5/10/2024 9:47 PM

Date Entered: 5/14/2024 9:44 PM

Date Est. Completed: 6/18/2024 7:56 PM

Price List: OHCO8X\_MAY24  
Restoration/Service/Remodel

Estimate: 2BDH2\_WINCHESTER\_-5

This estimate of repair contains our repair recommendations, subject to review by the insurance company. No adjuster has authority to authorize repairs or guarantee payment.

Any person who knowingly and with intent to defraud any insurance company or another person, files a statement of claim containing any materially false information, or conceals for the purpose of misleading, information concerning any fact, material thereto, commits a fraudulent insurance act, which is a crime, subject to criminal prosecution.

T. Barrett and Associates  
 P.O. Box 5069  
 Louisville, KY 40255  
 Office: 502-365-1462  
 Fax: 502-290-2091  
 admin@tbaclaims.com

**2BDH2\_WINCHESTER\_-5**  
**BLDG 5 - 5667-5683 Weatherby**  
**Roof**

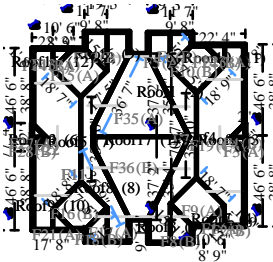

**Roof4**

8778.77 Surface Area	87.79 Number of Squares
535.43 Total Perimeter Length	222.60 Total Ridge Length
149.18 Total Hip Length	

**DESCRIPTION**

**QTY**

1. Remove Laminated - comp. shingle rfg. - w/out felt	87.79 SQ
2. Laminated - comp. shingle rfg. - w/out felt	96.67 SQ
3. Roofing felt - 15 lb.	78.14 SQ
4. R&R Valley metal - (W) profile	307.89 LF
5. Ice & water barrier	965.00 SF
6. R&R Drip edge	535.43 LF
7. Asphalt starter - universal starter course	321.67 LF
8. Continuous ridge vent - shingle-over style	80.00 LF
9. Flashing - pipe jack	16.00 EA
10. Hip / Ridge cap - Standard profile - composition shingles	222.60 LF
11. R&R Roof vent - turtle type - Metal	20.00 EA
12. Remove Additional charge for steep roof - 7/12 to 9/12 slope	52.84 SQ
13. Additional charge for steep roof - 7/12 to 9/12 slope	52.84 SQ
14. Remove Additional charge for high roof (2 stories or greater)	87.79 SQ
15. Additional charge for high roof (2 stories or greater)	87.79 SQ
16. Detach & Reset Wireless network antenna	1.00 EA
17. R&R Flashing - kick-out diverter	4.00 EA

NOTES:

T. Barrett and Associates  
 P.O. Box 5069  
 Louisville, KY 40255  
 Office: 502-365-1462  
 Fax: 502-290-2091  
 admin@tbaclaims.com

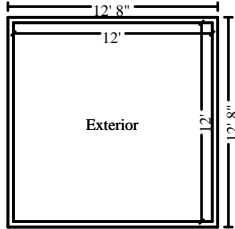

**Exterior**

**Height: 8'**

384.00 SF Walls	144.00 SF Ceiling
528.00 SF Walls & Ceiling	144.00 SF Floor
16.00 SY Flooring	48.00 LF Floor Perimeter
48.00 LF Ceil. Perimeter	

**DESCRIPTION**

**QTY**

18. R&R Siding - vinyl	30.00 SF
------------------------	----------

NOTES:

**Labor Minimums Applied**

**DESCRIPTION**

**QTY**

19. Electrical labor minimum	1.00 EA
20. Siding labor minimum	1.00 EA

NOTES:

**Grand Total Areas:**

384.00 SF Walls	144.00 SF Ceiling	528.00 SF Walls and Ceiling
144.00 SF Floor	16.00 SY Flooring	48.00 LF Floor Perimeter
0.00 SF Long Wall	0.00 SF Short Wall	48.00 LF Ceil. Perimeter
144.00 Floor Area	160.44 Total Area	384.00 Interior Wall Area
996.59 Exterior Wall Area	50.67 Exterior Perimeter of Walls	
8,778.77 Surface Area	87.79 Number of Squares	535.43 Total Perimeter Length
222.60 Total Ridge Length	149.18 Total Hip Length	