

T. Barrett & Associates
Address: PO Box 5069
Louisville, KY 40255
Phone: 502.365.1462
Fax: 502.290.2091
Toll Free: 1-877-770-1113

Insured: Winchester Lake Apartments LLC
Property: 6680-6708 Kodiak Drive
Canal Winchester, OH 43110

Business: (614) 317-1781

Claim Rep.: Bob Greaser
Company: T. Barrett and Associates

Business: (317) 522-6757
E-mail: bobgreaser@yahoo.com

Estimator: Bob Greaser
Company: T. Barrett and Associates

Business: (317) 522-6757
E-mail: bobgreaser@yahoo.com

Claim Number: 2BDH3

Policy Number: HEICP-250163

Type of Loss: Wind Damage

Date Contacted: 5/1/2024 5:37 PM

Date of Loss: 3/14/2024 6:31 PM

Date Received: 5/1/2024 6:32 PM

Date Inspected: 5/17/2024 6:32 PM

Date Entered: 5/17/2024 6:29 PM

Date Est. Completed: 7/15/2024 5:57 PM

Price List: OHCO8X_MAY24
Restoration/Service/Remodel

Estimate: 2BDH3_WINDCHES_BL5

This estimate of repair contains our repair recommendations, subject to review by the insurance company. No adjuster has authority to authorize repairs or guarantee payment.

Any person who knowingly and with intent to defraud any insurance company or another person, files a statement of claim containing any materially false information, or conceals for the purpose of misleading, information concerning any fact, material thereto, commits a fraudulent insurance act, which is a crime, subject to criminal prosecution.

T. Barrett & Associates
 Address: PO Box 5069
 Louisville, KY 40255
 Phone: 502.365.1462
 Fax: 502.290.2091
 Toll Free: 1-877-770-1113

2BDH3_WINDCHES_BL5
BLDG 5 - 6680-6708 Kodiak Drive
Roof

Roof 5

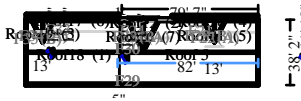

6437.13 Surface Area	64.37 Number of Squares
577.82 Total Perimeter Length	180.75 Total Ridge Length

DESCRIPTION	QTY
1. Remove Laminated - comp. shingle rfg. - w/out felt	64.37 SQ
2. Laminated - comp. shingle rfg. - w/out felt	71.00 SQ
3. Roofing felt - 15 lb.	47.14 SQ
4. Ice & water barrier	1550.03 SF
In valleys.	
5. R&R Valley metal - (W) profile - painted	108.59 LF
6. R&R Drip edge	577.82 LF
7. Asphalt starter - universal starter course	408.08 LF
8. Continuous ridge vent - shingle-over style	160.75 LF
9. Hip / Ridge cap - Standard profile - composition shingles	180.75 LF
10. Flashing - pipe jack	24.00 EA
11. Roof vent - turtle type - Metal	16.00 EA
12. Remove Additional charge for high roof (2 stories or greater)	54.40 SQ
13. Additional charge for high roof (2 stories or greater)	54.40 SQ
14. Remove Additional charge for steep roof - 7/12 to 9/12 slope	4.99 SQ
15. Additional charge for steep roof - 7/12 to 9/12 slope	4.99 SQ

NOTES:

T. Barrett & Associates
 Address: PO Box 5069
 Louisville, KY 40255
 Phone: 502.365.1462
 Fax: 502.290.2091
 Toll Free: 1-877-770-1113

Grand Total Areas:

384.00 SF Walls	144.00 SF Ceiling	528.00 SF Walls and Ceiling
144.00 SF Floor	16.00 SY Flooring	48.00 LF Floor Perimeter
0.00 SF Long Wall	0.00 SF Short Wall	48.00 LF Ceil. Perimeter
144.00 Floor Area	160.44 Total Area	384.00 Interior Wall Area
2,099.94 Exterior Wall Area	50.67 Exterior Perimeter of Walls	
6,437.13 Surface Area	64.37 Number of Squares	577.82 Total Perimeter Length
180.75 Total Ridge Length	0.00 Total Hip Length	